

DROP-OFF PROCEDURE

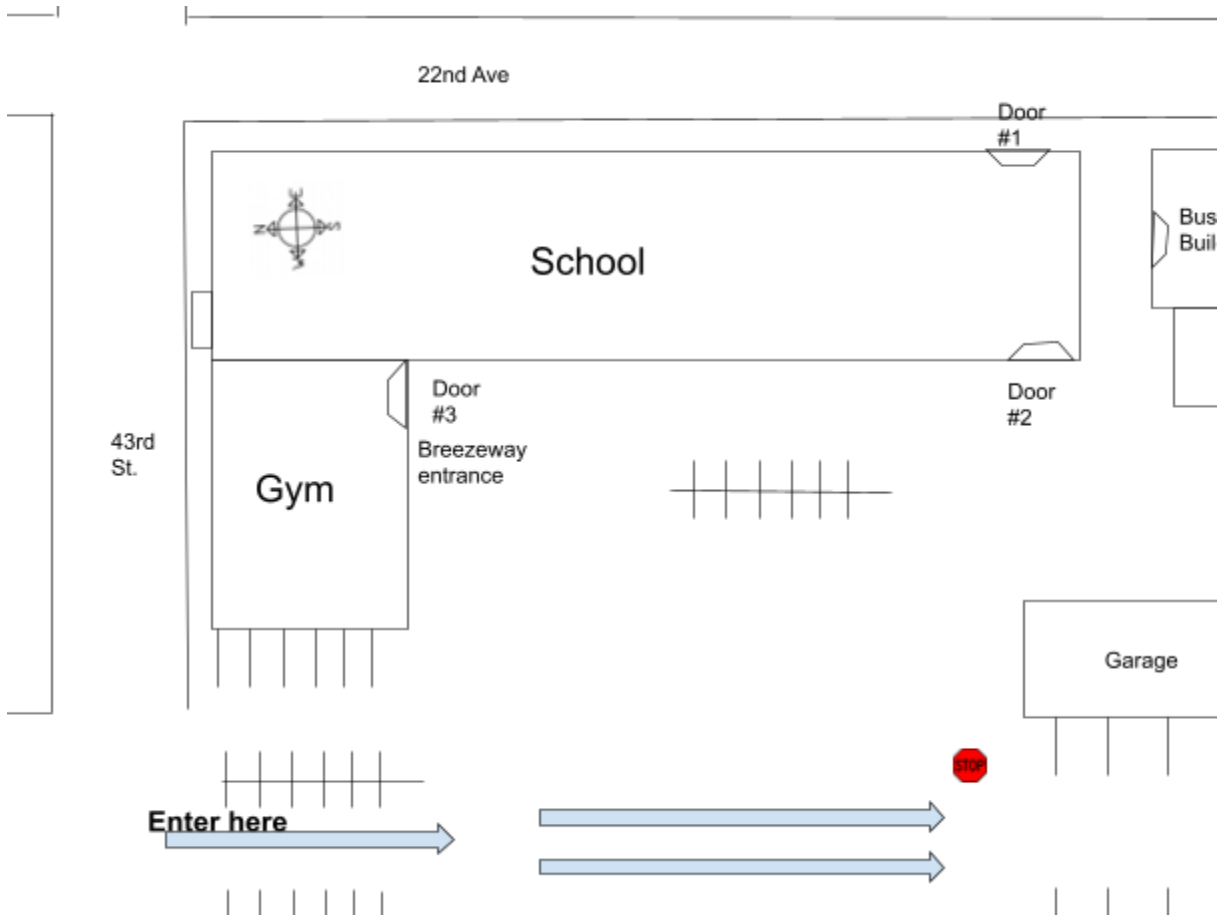

ARRIVAL

- All Saints Catholic School will provide supervision of students beginning at 7:30 a.m. Any students dropped off prior to 7:30 a.m. must go to the Cardinal Care program.
- Students may enter the building beginning at 7:30 a.m. In the event of inclement weather, students may enter the building at 7:20 a.m. and go to homerooms.
- Students may use either the breezeway entrance or the southwest entrance until 7:40 a.m. After 7:40 a.m., students may ONLY use the southwest entrance.

DROP-OFF PROCEDURE

- Please enter the parking lot via the 43rd Street entrance.
- Enter the second entrance to continue to the two drop off lanes. If one is full, please enter the other. Stop at the two big cones where the Safety Patrol will assist you in unloading students. If all cars are stopped, your students may exit their vehicle before getting to the cones. Students in the left lane should go left, directly onto the playground. Students in the right lane should exit on the right and walk to the cones for safe crossing by the safety patrol. Please be patient for the safety of all.
- Please proceed cautiously to the 45th Street exit.
- Do not park or drop your child off in the teacher lot near the entrance on 43rd street.

PICK-UP PROCEDURE

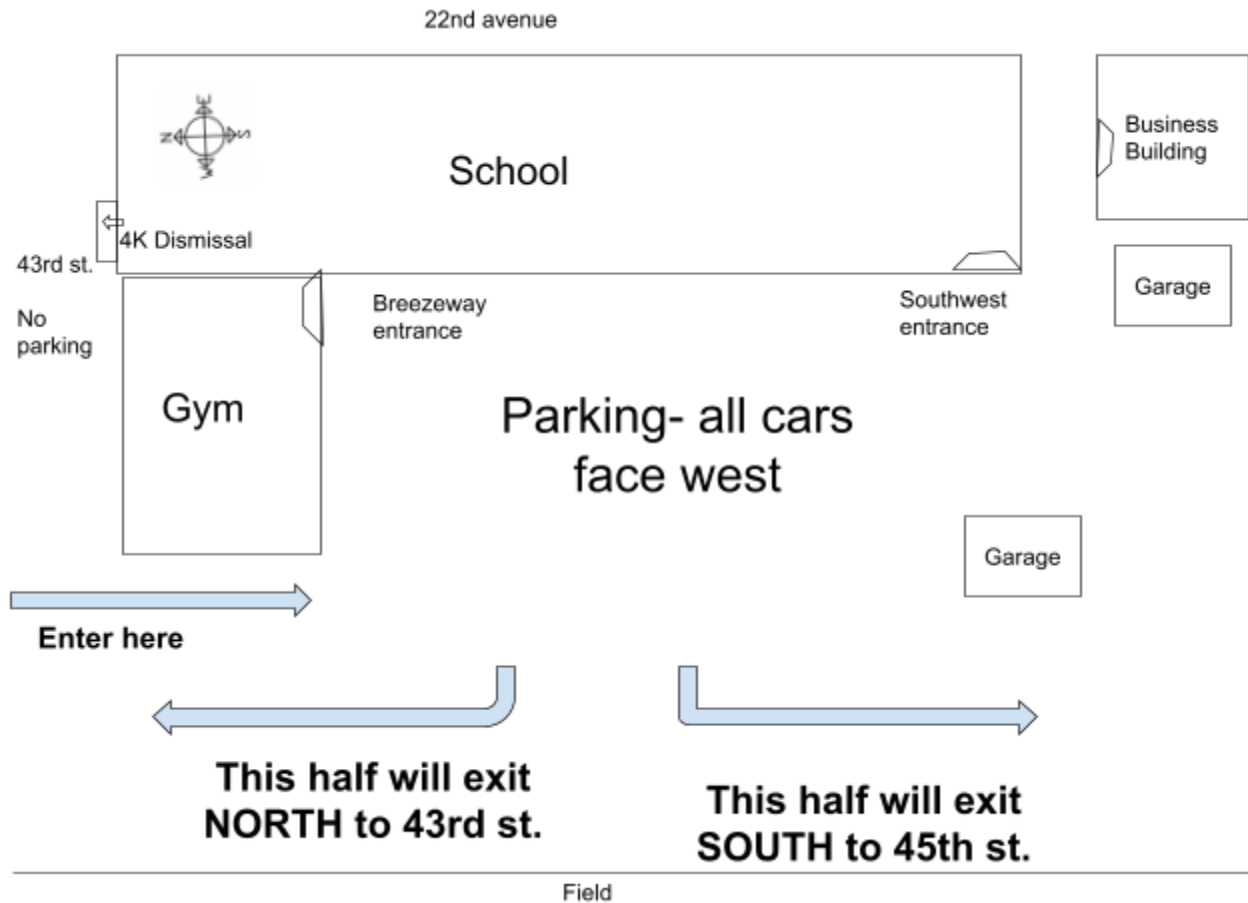

PICK-UP PROCEDURE

- Please enter the parking lot via the 43rd Street entrance and park **FACING WEST** in a designated space (with the exception of the row of vehicles furthest west backed in).
- Students in 4K & 5K will exit through door #6 on the north side of the building; parents please come get your children.
- Students in grades 3-5 will exit the building using the southwest doors (#2).
- Students in SIT, Gr. 1-2 will exit the building using the northwest/breezeway doors (#3).
- Students in grades 6-8 may choose to use either exit.
- Cars don't move until Safety Patrol releases cars. Please be patient for the safety of all.
- Please follow the lead of the Safety Patrol and exit via the 43rd or 45th Street exit

DISMISSAL

- Supervision will be provided for 10 minutes after school. Any students remaining after school hours must have parental permission and be under teacher/adult supervision.
- Students remaining after this will be sent to the Cardinal Care program. Applicable fees for the after school care program will be assessed.